

DECK PLANS | REGATTA & NAUTICA

SYMBOL LEGEND

- | | | |
|---------------------|-------------------------|----------------------------------------------|
| ♣♣ Restrooms | ■ Quad with Pullman | ▲ Triple with Pullman |
| E Elevator | ★ ★ Quad with Sofabed | ★ Triple with Sofabed |
| 👕 Launderette | Connecting Staterooms | ◇ 3rd guest occupancy available upon request |
| OV Obstructed Views | ♿ Wheelchair Accessible | |

STATEROOM COLOR LEGEND

| | | | | | | | |
|----|----|-----|-----|-----|----|----|----|
| OS | VS | PH1 | PH2 | PH3 | A1 | A2 | A3 |
| B1 | B2 | C1 | C2 | D | S | F | G |

SHIPS' SPECIFICATIONS

Year Built: *Regatta* 1998; *Nautica* 2000 | Re-Inspiration Dates: *Regatta* 2019; *Nautica* 2022
 Gross Tonnage: 30,277 | Length: 593.7 feet | Beam: 83.5 feet | Cruising Speed: 18 knots | Guest Decks: 9
 Guest Capacity (Double Occupancy): 656 | Staff Size: 400 | Guest-to-Staff Ratio: 1.64 to 1
 Nationality of Officers: European | Country of Registry: Marshall Islands

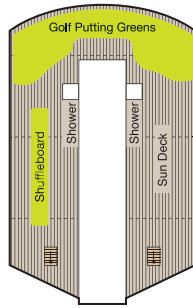

DECK 11

- Golf Putting Greens
- Shuffleboard
- Sun Deck

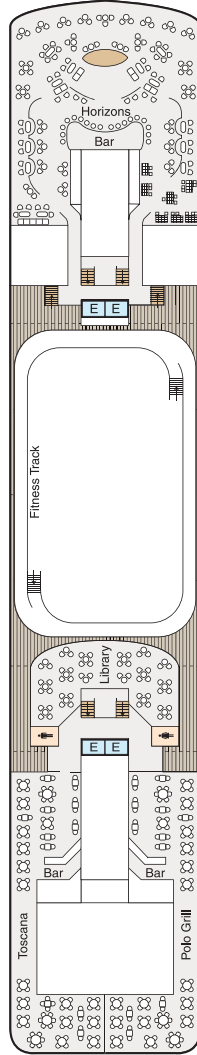

DECK 10

- Toscana
- Polo Grill
- Library
- Fitness Track
- Horizons

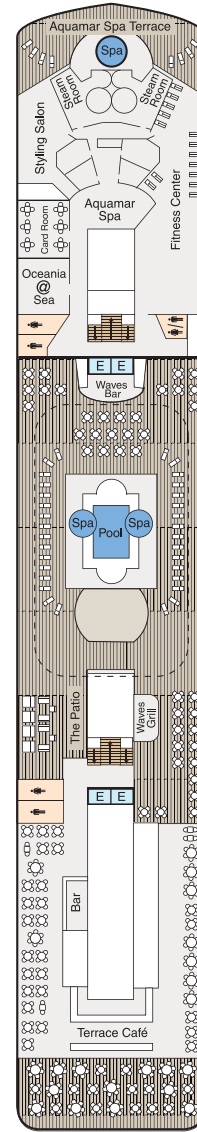

DECK 9

- Terrace Café
- Waves Grill
- Waves Bar
- Pool Deck
- Oceania@Sea
- Aquamar Spa + Vitality Center
- Aquamar Spa Terrace
- Fitness Center
- Salon

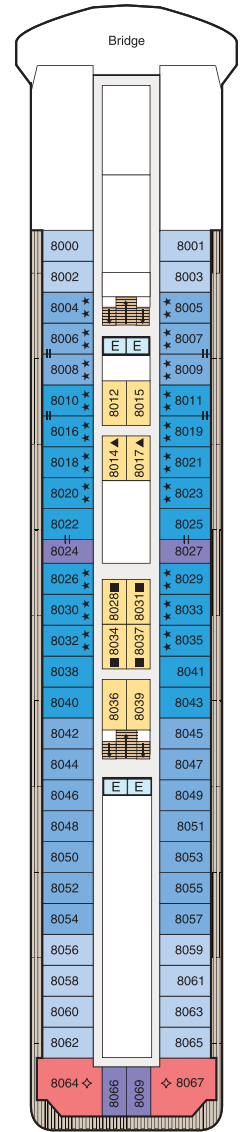

DECK 8

- Bridge
- Staterooms

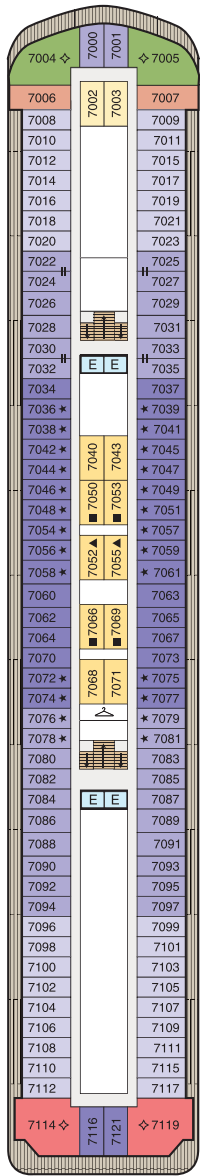

DECK 7
 • Launderette
 • Staterooms

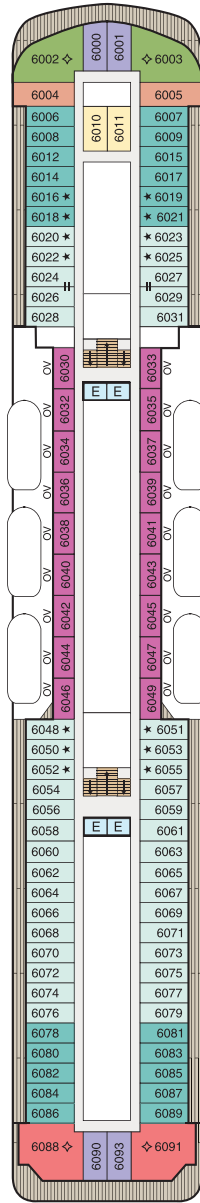

DECK 6
 • Staterooms

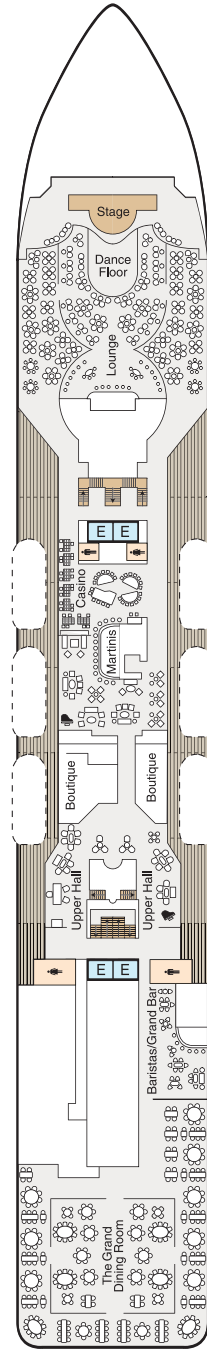

DECK 5
 • Show Lounge
 • Boutiques
 • Upper Hall
 Oceania Club
 Ambassador Desk
 • Martinis
 • Casino
 • Baristas
 The Grand Bar
 • The Grand
 Dining Room

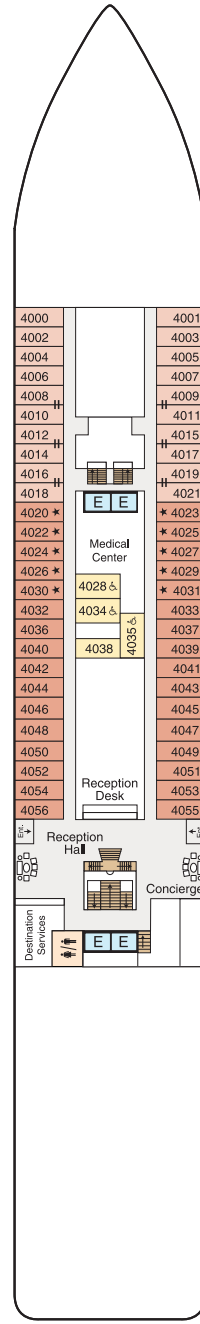

DECK 4
 • Reception Desk
 • Reception Hall
 • Destination
 Services
 • Concierge
 • Medical Center
 • Staterooms

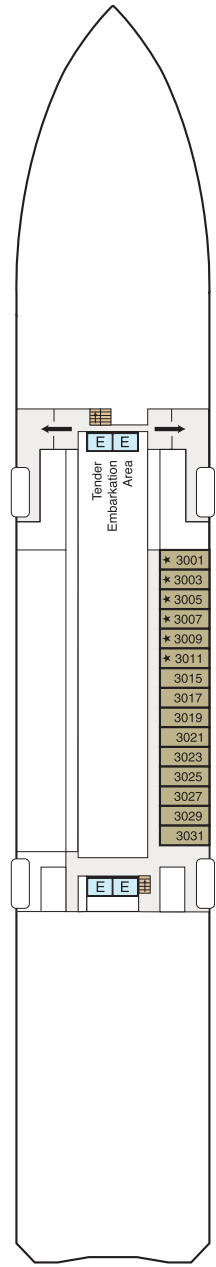

DECK 3
 • Staterooms